



### INTRODUCTION:

>The manufacturer's instructions must be provided to users of this product. The user must read and understand these instructions before installing this equipment. Alterations to this product, misuse of this product, or failure to follow instructions may result in serious injury or death.

>Once properly installed, the SRL-P Adapter is designed to connect to the dorsal D-ring's built-in SRL-P tunnel located in a variety of competitor's full body harnesses. A Competent Person must confirm proper installation prior to use.

### INSPECTION:

>Prior to initial installation or subsequent removal and reinstallation\*, the user must ensure that the SRL-P Adapter has no visible damage or defects. If any damage or defects are found, the user must IMMEDIATELY remove the product from service. \*If reinstalled, the lock nut of the adapter must be replaced with another M8 x 1.25 Nylon Insert Lock Nut.

>Inspect all components of the product for deficiencies or damage including, but not limited to, abrasion, discoloration, burns, holes, mold, and damaged, missing, or illegible labels.

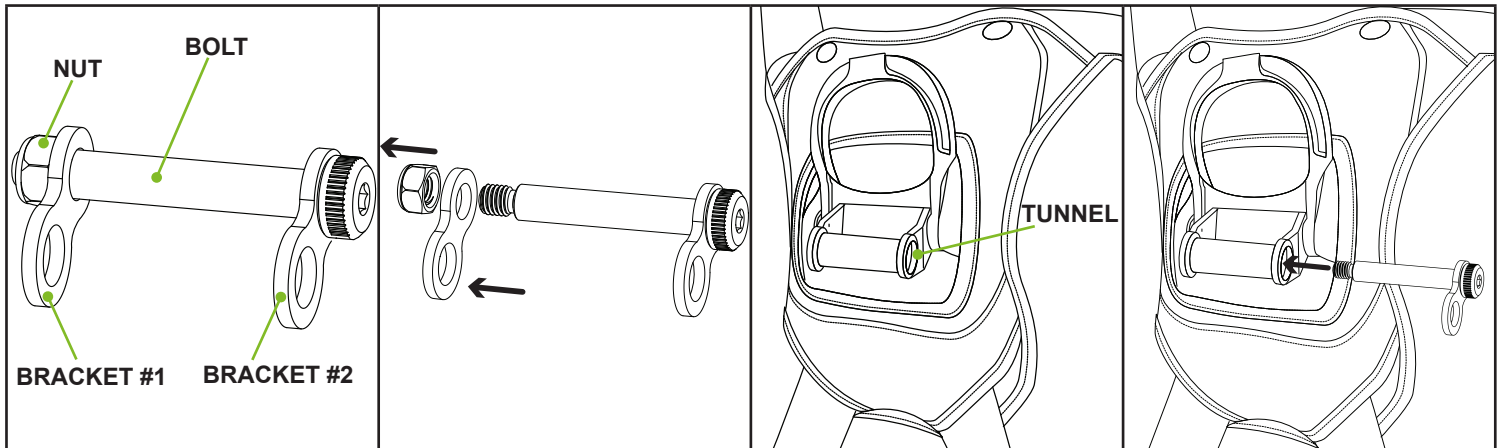

**1:** Ensure all components of the SRL-P Adapter are present. The adapter consists of a bolt, two brackets, and a lock nut.

**2:** Remove the lock nut and bracket #1 from the SRL-P Adapter.

**3:** Locate the intended installation location (SRL tunnel) on the Dorsal D-ring of a full body harness.

**4:** With bracket #2 of the adapter still on, slide the bolt of the SRL-P Channel through the SRL tunnel.

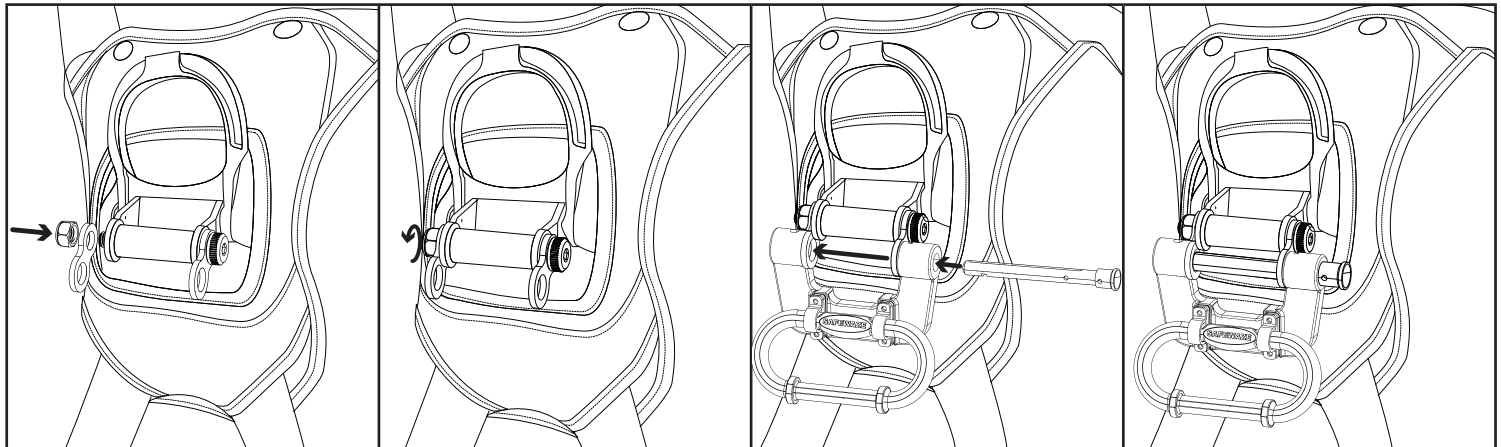

**5:** Place bracket #1 onto the bolt. Then, place the lock nut back onto the bolt's end.

**6:** Secure bracket #1 and the lock nut onto the bolt. Tighten the lock nut until only 2-3 threads are exposed.

**7:** Now, a SRL-P connector can be attached to the two brackets of the SRL-P Adapter.

**8:** Ensure that the SRL-P connector has fully passed through both brackets of the SRL-P Adapter and is securely closed.