

NORTHSTAR

COASTAL EDGE

Maximum protection in corrosive environments

NORTHSTAR

EDGE

Extreme endurance for the dirty jobs

Engineered to Lead. Built to Last.

- Patented cable retraction limiter
- Simplified cable replacement system
- Innovative anti-ratcheting, oscillating pawls
- Protective semi-sealed internal assemblies

Northstar Coastal Edge boasts all the same features plus enhanced corrosion protection for extreme environments with salt water or high humidity found in marine, coastal and industrial applications—without the cost or complexity of fully sealed block designs.

CLASS

2

Anchor above or below dorsal D-ring

Advanced design proactively eliminates top SRL failures:

1. Cable wear & tear
2. Pawl damage
3. Broken mainspring



PROTECTIVE SEMI-SEALED ASSEMBLY with RUBBER GASKET

Protects critical components—dirt, dust and debris can't enter housing

INNOVATIVE PAWL DESIGN

- Anti-ratcheting: prevents premature disengagement for use on flexible anchor points, including HLLs
- Oscillating: prevents payout when pawls are frozen, keeping workers safe

PATENTED CABLE RETRACTION LIMITER ELIMINATES DANGEROUS FREEWHEELING

- Engineered to control cable return speed, extending product life and improving overall jobsite safety:
- Minimizes impact on the SRL to limit damage on internal components
 - Protects the anchor, structure and surrounding equipment
 - Increases safety for all workers in area

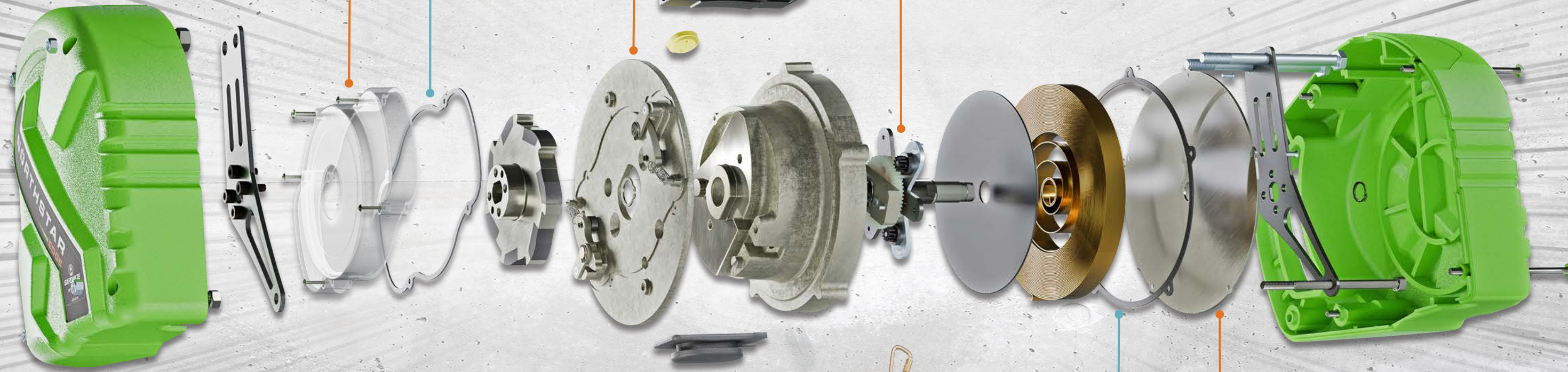

PROTECTIVE SEMI-SEALED ASSEMBLY with RUBBER GASKET

Protects critical mainspring from contamination and maintains lubrication to prevent drying out

SIMPLIFIED CABLE REPLACEMENT SYSTEM

Repair completed in under 10 minutes by trained Competent Person for extended SRL life and less down time on the job



10x MORE
corrosive-resistant
than traditional
SRLs

- **AFFORDABLE ALTERNATIVE TO SEALED BLOCK**
All the durability without the added cost and weight of fully sealed block designs
- **ALL ALUMINUM & STAINLESS-STEEL COMPONENTS**
Enhanced corrosion resistance in coastal, marine and high-humidity environments
- **1ST STAINLESS STEEL CLASS 2 ON THE MARKET**

Meets both
CLASS 1
CLASS 2
requirements

Industry-leading engineering. Long-lasting durability.

ALL THE NECESSARY EXTRAS

NORTHSTAR EDGE

NORTHSTAR COASTAL EDGE



Length	Northstar Edge	Northstar Coastal Edge
20'	022-5300	022-5292
30'	022-5301	022-5293
50'	022-5302	022-5294

Key Specs:

Materials: Polyester shock pack, polycarbonate housing, rubber handle
Edge: 3/16" Galvanized steel cable, steel and stainless-steel components
Coastal Edge: 13/64" Stainless steel cable, aluminum and stainless-steel components
ANSI Weight Capacity: 130-310 lbs. (59-141 kg)
OSHA Weight Capacity: Up to 420 lbs. (191 kg)
Standards: ANSI Z359.14-2021, OSHA 1910.140, 1910.66

CLASS
2
Anchor above or below dorsal D-ring





SAFEWAZE



SHIPPING LOCK NOTICE

The Northstar Edge and Coastal Edge are equipped with retraction limiters, it is still possible to lock the pawls during transportation or use. This is due to the elongated pawls, which provide these devices with added security when being used on flexible anchor points such as Horizontal Lifelines.

HOW TO RELEASE LOCKED CABLE

If the lifeline will not extend:

- 1** Place the SRL on the ground with the cable side facing down to keep the unit properly aligned.
- 2** Tilt the SRL and hold the lifeline handle firmly with one hand.
- 3** Using your other hand, push the lifeline back into the housing. The handle is spring-loaded and will allow slight inward movement. This inward movement will disengage the internal pawls.
- 4** Once released, slowly pull the lifeline out in a smooth, controlled motion to resume normal operation.

WHY THIS HAPPENS

The Northstar SRL uses a highly responsive pawl system designed to engage quickly during sudden movement. This same feature that ensures rapid fall arrest can occasionally activate during transit.

WATCH HOW TO RESET

Scan the QR code below for a quick video demonstration.



Engineered for fast engagement and reliable fall protection when it matters most.



225 Wilshire Avenue SW, Concord NC 28025
800-230-0319 • safewaze.com

