

NORTHSTAR

COASTAL EDGE

Maximum protection in corrosive environments

NORTHSTAR

EDGE

Extreme endurance for the dirty jobs

Engineered to Lead. Built to Last.

- Patented cable retraction limiter
- Simplified cable replacement system
- Innovative anti-ratcheting, oscillating pawls
- Protective semi-sealed internal assemblies

Northstar Coastal Edge boasts all the same features plus enhanced corrosion protection for extreme environments with salt water or high humidity found in marine, coastal and industrial applications—without the cost or complexity of fully sealed block designs.

CLASS

2

Anchor above or below dorsal D-ring

Advanced design proactively eliminates top SRL failures:

1. Cable wear & tear
2. Pawl damage
3. Broken mainspring



PROTECTIVE SEMI-SEALED ASSEMBLY with RUBBER GASKET

Protects critical components—dirt, dust and debris can't enter housing

INNOVATIVE PAWL DESIGN

- Anti-ratcheting: prevents premature disengagement for use on flexible anchor points, including HLLs
- Oscillating: prevents payout when pawls are frozen, keeping workers safe

PATENTED CABLE RETRACTION LIMITER ELIMINATES DANGEROUS FREEWHEELING

- Engineered to control cable return speed, extending product life and improving overall jobsite safety:
- Minimizes impact on the SRL to limit damage on internal components
 - Protects the anchor, structure and surrounding equipment
 - Increases safety for all workers in area

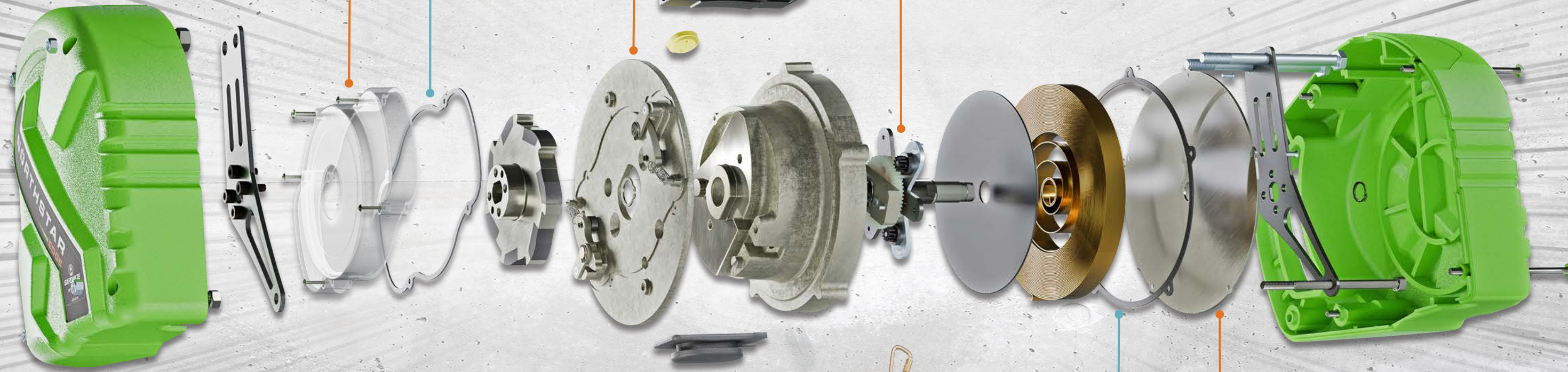

PROTECTIVE SEMI-SEALED ASSEMBLY with RUBBER GASKET

Protects critical mainspring from contamination and maintains lubrication to prevent drying out

SIMPLIFIED CABLE REPLACEMENT SYSTEM

Repair completed in under 10 minutes by trained Competent Person for extended SRL life and less down time on the job



- **AFFORDABLE ALTERNATIVE TO SEALED BLOCK**
All the durability without the added cost and weight of fully sealed block designs
- **ALL ALUMINUM & STAINLESS-STEEL COMPONENTS**
Enhanced corrosion resistance in coastal, marine and high-humidity environments
- **1ST STAINLESS STEEL CLASS 2 ON THE MARKET**

10x MORE
corrosive-resistant
than traditional
SRLs

Meets both
CLASS 1
CLASS 2
requirements

Industry-leading engineering. Long-lasting durability.

ALL THE NECESSARY EXTRAS

NORTHSTAR EDGE

NORTHSTAR COASTAL EDGE



Length	Northstar Edge	Northstar Coastal Edge
20'	022-5300	022-5292
30'	022-5301	022-5293
50'	022-5302	022-5294

Key Specs:

Materials: Polyester shock pack, polycarbonate housing, rubber handle
Edge: 3/16" Galvanized steel cable, steel and stainless-steel components
Coastal Edge: 13/64" Stainless steel cable, aluminum and stainless-steel components
ANSI Weight Capacity: 130-310 lbs. (59-141 kg)
OSHA Weight Capacity: Up to 420 lbs. (191 kg)
Standards: ANSI Z359.14-2021, OSHA 1910.140, 1910.66

CLASS
2
Anchor above or below dorsal D-ring

