



KEEP YOUR ROOF WATERTIGHT

CORRUGATED ROOF ANCHOR

Versatile, reusable fall protection for corrugated roofs. Features a 360° swivel D-ring for mobility and allows fasteners to be reinstalled after anchor removal to maintain waterproofing and roof integrity.



024-4112
Corrugated Roof Anchor:
Anchor: Steel

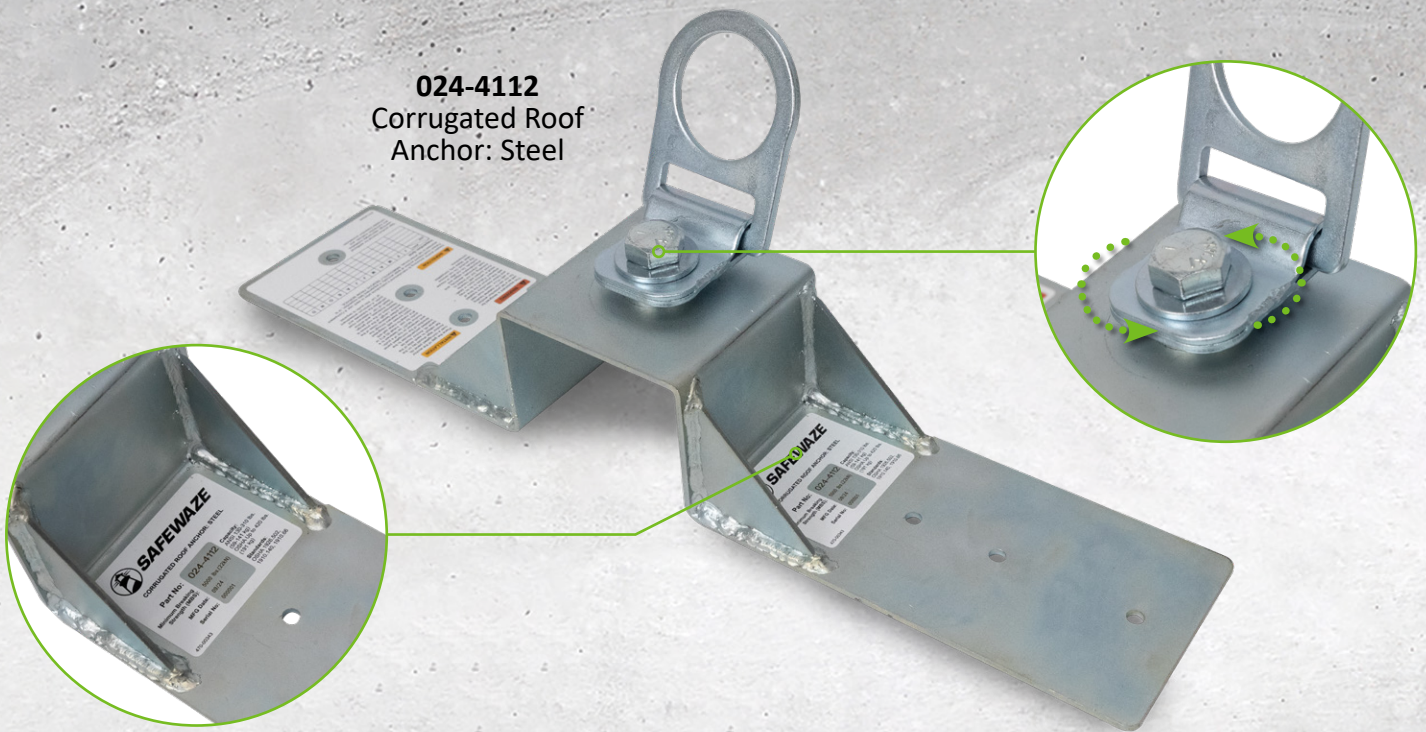

» **MAINTAIN ROOF INTEGRITY**

Reinstall fasteners after anchor removal to prevent leaks and preserve the roof's structure

» **INCREASE PRODUCTIVITY**

360° swivel D-ring allows seamless movement for increased efficiency

» **VERSATILE USE**

Raised platform fits corrugated roofs with ridge heights up to 1-3/4" and widths up to 3-3/4"

» **BUILT TO LAST**

Laser-engraved critical data ensures durability and extends service life

Also available in durable stainless steel for enhanced corrosion resistance



024-4113
Corrugated Roof Anchor:
Stainless Steel

OTHER ROOF ANCHOR PRODUCTS:



019-4005

FS-EX310-1

022-4084

KEY SPECS:

Materials: Zinc-plated Steel or Stainless Steel
Dimensions: 20.1" x 4" x 2.9"
(510 mm x 101.5 mm x 74 mm)
MBS: 5,000 lbs. (22 kN)
OSHA Standards: 1926.502, 1910.140, 1910.66
Minimum embedment of 1/4" into purlin required
Fasteners not included

