



SAFEWAZE

FS875

OPERATION INSTRUCTIONS

ROPE TERMINATION DIRECTIONS

Rope is secured in the FS875 Termination Plate by weaving the rope through the five holes in the termination plate from the bottom to the top (See Step 2 in illustration below). Rope is tucked around and under the loop formed between the top two lacing holes #4 and #5 of the plate (See Steps 3 & 4 in illustration below). Rope is tightened by pulling on the loose end of the rope. There should be at least 18 inches of loose rope left after cinching. (See Step 5 in illustration below)

**Recommended Rope Types:
5/8" and 3/4" dia 3-strand polyester rope**

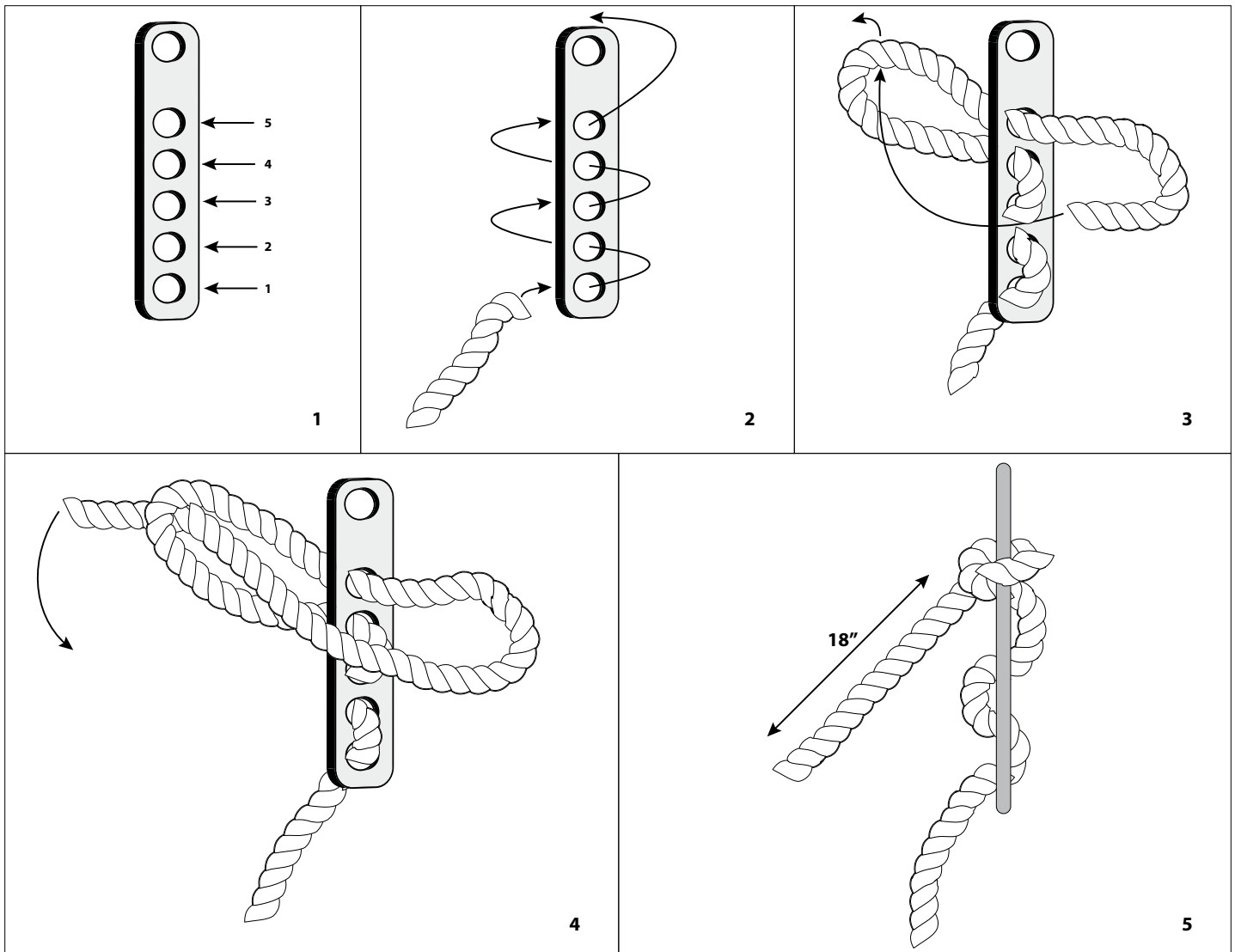

SPECIFICATIONS

Capacity (fall arrest): One person with a combined total weight of 310 lb (140 kg), including clothing, tools and other equipment.

Capacity (rescue): Up to two persons with a combined total weight of 600 lb (272 kg).

FS875 meets OSHA, ANSI Z359.1 and ANSI A10.32 requirements for an anchorage connector component for fall arrest.

Use only as part of a complete fall arrest system for one worker that limits free fall distance to 6 feet or less, and limits fall arrest forces to 1,800 lbs (8 kN) or less.

INSPECTION PROCEDURES

1. Inspect the rope and termination plate prior to each use, and each time the system is moved to a new work location. Look for evidence of cuts, wear, fraying, grease, oil, glue, tar, spatter, or any other condition that could affect the integrity of the termination plate or strength of the rope.
2. Discard rope if subjected to fall arrest forces.
3. Inspect the carabiner used for connection to the termination plate. Gate should open and close smoothly and lock automatically.
4. Ensure rope is not exposed to sharp or abrasive surfaces.



THESE INSTRUCTIONS MUST BE PROVIDED TO THE USER. USER MUST READ AND UNDERSTAND THESE INSTRUCTIONS. FAILURE TO DO SO COULD RESULT IN INJURY OR DEATH.

- During termination, ensure that the rope is tucked under the loop formed between holes #4 and #5 (See Steps 3 & 4 in illustration)
- Ensure there is a minimum of 18 inches of rope beyond the bottom of the termination plate.
- Use only approved rope with the FS875 Rope Termination Plate. Undersized rope may slide out of the termination plate due to insufficient friction.
- Protect the rope from sharp or abrasive surfaces or edges.
- Inspect to ensure rope is free of any oils or other lubricants.
- Use only approved anchor points per OSHA, ANSI and local regulations.

Safewaze

225 Wilshire Ave SW
Concord, NC 28025, USA

Tel: (800)230-0319

www.safewaze.com