

SAFEWAZE

SAFEWAZE TOOLCUFFS™

Tool Lanyard

User Instruction Manual

| Part # | Description | Max Tool Weight |
|---|---|-----------------|
| Tool Attachments and Accessories | | |
| SW400 | D-ring Tool Attachment 0.5" x 2.25" | 2 lbs. |
| SW402 | D-ring Tool Attachment 1" x 3.5" | 5 lbs. |
| SW404 | MD Cinch Tool Attachment 1" x 11" (No Tabs) | 35 lbs. |
| SW406 | MD Cinch Tool Attachment 1" x 11" | 35 lbs. |
| SW407 | HD Cinch Tool Attachment 1" x 15" | 80 lbs. |
| SW408 | D-ring Tool Attachment 1" x 8" | 15 lbs. |
| SW422 | Yellow Tool Tape 2" x 9' (Individual Roll) | N/A |
| SW422-10 | Yellow Tool Tape 2" x 9' (Box of 10 Rolls) | N/A |
| SW423 | Blue Tool Tape 1" x 9' (Individual Roll) | N/A |
| SW423-10 | Blue Tool Tape 1" x 9' (Box of 10 Rolls) | N/A |
| SW425 | Elasticated Tool Attachment 1" x 11" | 5 lbs. |
| SW426 | Tool Ring - Small .75" | 2 lbs. |
| SW428 | Tool Ring - Large 1.5" | 2 lbs. |
| Tool Tethers | | |
| SW411 | Coil Tool Tether 14" to 68" Length | 5 lbs. |
| SW414 | Coil Tool Tether 28" to 74" Length | 2 lbs. |
| SW416 | Tool Tether 12" | 5 lbs. |
| SW417 | Tool Tether 24" | 5 lbs. |
| SW431 | MD Elasticated Tool Tether with Swivel Carabiner | 35 lbs. |
| SW432 | MD Elasticated Tool Tether with 2 Swivel Carabiners | 35 lbs. |
| SW433 | MD Elasticated Tool Tether with Swivel Carabiner | 80 lbs. |
| SW434 | HD Elasticated Tool Tether with 2 Swivel Carabiners | 80 lbs. |
| SW435 | Retractable Tool Tether | 5 lbs. |
| SW436 | Elasticated Tool Tether with 2 Non-Swivel Carabiners | 15 lbs. |
| SW437 | Retractable Tool Tether | 1 lbs. |
| SW438 | Elasticated Tool Tether with 1 Carabiner and Cinch Loop | 15 lbs. |
| Wrist System | | |
| SW424 | Wrist Tool Lanyard with 25mm stainless D-ring | 5 lbs. |



WARNING

The manufacturer's instructions must be provided to users of this equipment. The user must follow the manufacturer's instructions for each component of the system. The user must read and understand these instructions before using this equipment. Manufacturer's instructions must be followed for proper use and maintenance of this equipment. Alterations to this product, misuse of this product, or failure to follow instructions may result in serious injury or death.

IMPORTANT

Questions regarding the use, care, or suitability of this equipment for your application? Contact SAFEWAZE™.

IMPORTANT

Record identification information before using this product. Identification information may be found on the equipment label. This information should be recorded in the "Inspection Log" located at the back of this manual.

This manual is intended to meet the manufacturer's instructions and should be used as part of an employee training program as required by ANSI/ISEA 121-2018 and OSHA.

User Information

Date of First Use: _____

Serial#: _____

Trainer: _____

User: _____

Do not throw away these instructions!
Read and understand these instructions before using equipment!

INTRODUCTION

Thank you for purchasing a SAFEWAZE™ ToolCuff Product. This manual must be read and understood in its entirety, and used as part of an employee training program as required by OSHA or any applicable state agency.

This manual and any other instructional material must be available to the user of the equipment. The user must understand how to safely and effectively use their ToolCuff Product, and all equipment used in conjunction with the ToolCuff Product.

SAFETY INFORMATION

User must read, understand, and follow all safety information contained in these instructions prior to use of the ToolCuff Tool Lanyards.

FAILURE TO READ, UNDERSTAND, AND FOLLOW THESE INSTRUCTIONS MAY RESULT IN SERIOUS INJURY OR DEATH.

Product Usage:

ToolCuff Tool Lanyards are designed to protect workers from hazards that can result from a tool, equipment, etc., being dropped from an elevated work area onto work areas below. Personnel should always use ToolCuff Tool Lanyards when working at heights. Personnel working at heights with unsecured tools risk serious injury or damage to any personnel or equipment located below them.

Usage in any application other than those specifically addressed in this manual could result in serious injury or death.

Users should be trained in the proper usage of these products as related to their specific workplace applications.



WARNING

ToolCuff Products are intended to be part of the users workplace fall protection plan. Users are expected to be fully trained in the safe installation and use of these products. **Unauthorized usage or misuse of this product could result in serious injury or death.** For questions regarding installation, proper usage, selection, or maintenance, refer to this User's Manual, consult a supervisor, or contact SafeWaze Technical Service.

In order to reduce the hazards of working at heights with tools, the following instructions must be followed in order to avoid the risk of serious injury or death:

- Do not connect any tool with a weight greater than 5 lbs (2.26 kg) to your body unless explicitly authorized per the ToolCuff Instructions.
- ToolCuff products are NEVER to be used as part of a PFAS (Personal Fall Arrest System) or Fall Restraint System.
- The maximum capacity of any ToolCuff Product must NEVER be exceeded.
- Each ToolCuff Product MUST be inspected prior to each use in accordance with the Instruction Manual.
- If a ToolCuff Product has been subject to fall arrest forces, it must be removed from service.
- Modifications or alterations to ToolCuff Products are not authorized nor permitted.
- Modifications to connected tools or products that may result in a deviation from the manufacturer's specifications or recommendations is not permitted.
- ToolCuff Products must never be attached to a tapered surface.
- Never make attachments tools or equipment in a manner that would allow the ToolCuff Product to be unintentionally disconnected.
- Do not tie or knot the ToolCuff Tool Lanyard. Only attach ToolCuff's per manufacturer instructions.
- Do not attempt to lengthen a ToolCuff Product by connecting multiple lanyards, or tethers together.
- Do not use a ToolCuff product if it will interfere with the safe operation, or usage of, any personal fall protection product or system.
- Ensure the ToolCuff Tool Lanyard is kept free from any and all obstructions including, but not limited to, entanglement with other workers, yourself, and surrounding objects.
- Never wrap ToolCuff components around sharp or abrasive edges.
- Do not use a ToolCuff Product if it will interfere with the safe working condition, or operation, of the tool or equipment it is attached to.
- Use extra precautions around moving machinery, electrical hazards, extreme temperatures, chemical hazards, explosive or toxic gasses, rough or sharp edges, or overhead materials that could injure the user or damage equipment.
- Only use compatible connections. Contact Safewaze prior to using this ToolCuff Product in combination with components or subsystems other than those described in the User Instructions.
- All connected tools and equipment, including connection points, must be compatible for use with ToolCuff Products. Tools and equipment should be properly maintained and inspected in accordance with the manufacturer's instructions.
- Ensure there is adequate clearance in the event of a tool drop. Tool fall/swing path must not endanger yourself, other personnel, or any surrounding equipment or materials.
- Always wear appropriate PPE when installing, using, or inspecting the ToolCuff Product/System.
- All procedures shown in these instructions are for ToolCuff Products only.
- All incidents of dropped tools should be reported to your supervisor or safety coordinator.

APPLICATIONS AND USAGE OF TOOLCUFF TOOL LANYARDS

- ToolCuff Tool Lanyards aid in the prevention of dropping heavy tools and/or equipment.
- ToolCuff Tool Lanyards provide an attachment point for tools weighing up to 80 lbs.
- Additional attachment tabs incorporated into specific ToolCuff products allow for an extra level of securement to a tool or equipment after cinching is complete.
- When attaching a ToolCuff product with additional attachment tabs, the user must use ToolCuff Tool Tape to secure the attachment tabs to the tool.
- D-ring Tool Attachments should be attached to the tool upon ensuring that both the tool and D-ring Tool Attachment is free of debris which could affect the performance of the ToolCuff Tape.
- Ensure that the D-ring Tool Attachment is located away from the tool's center of gravity.
- Do not precut tape. While maintaining tension on the tape, attach the beginning of the first wrap directly to the tool surface while ensuring the the D-ring Tool Attachment comes into contact with the first full wrap of tape.
- Ensure to maintain a moderate level of tension on the tape while attaching the D-ring Tool Attachment to the tool.
- For D-ring Tool Attachments with a capacity of 2 lbs. to 5 lbs. a minimum of 12 wraps of tape should be applied to ensure proper tool connection.
- After connection to the tool, user should ensure that the connection is solid with no slippage.

TOOLCUFF TOOL LANYARD APPROPRIATE USAGE

- ToolCuff Tool Lanyards part numbers SW404, SW406, SW431, and SW432 are for use with heavy tools weighing up to 35 lbs (15.9 kg)
- ToolCuff Tool Lanyards part numbers SW407, SW433, and SW434 are for use with heavy tools weighing up to 80 lbs (36.3 kg)
- ToolCuff Tool Cinch Lanyards are for use on difficult to tether heavy tools such as closed handle tools, clamps, large wrenches, etc...

TOOLCUFF TOOL LANYARD INAPPROPRIATE USAGE

- Do not use ToolCuff Tool Lanyards with tools that exceed the Maximum Load Rating of the lanyard.
- ToolCuff Tool Lanyards are not to be used with tools that have a tapered handle.

LABELING EXAMPLES

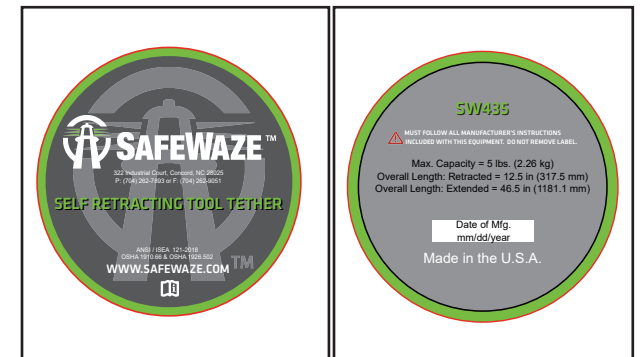

INSTALLATION AND USAGE EXAMPLES

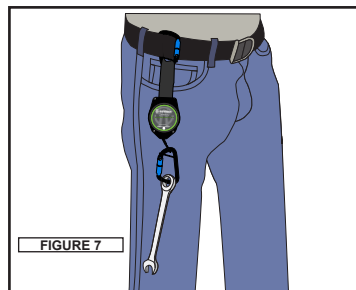
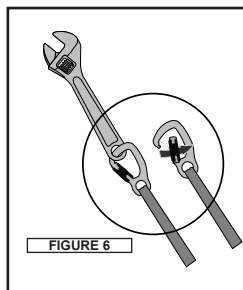
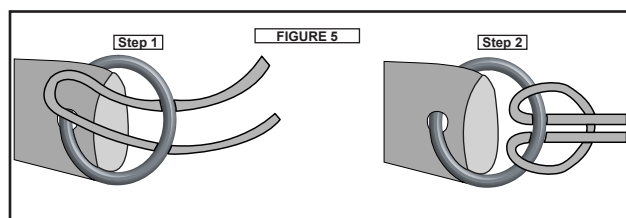
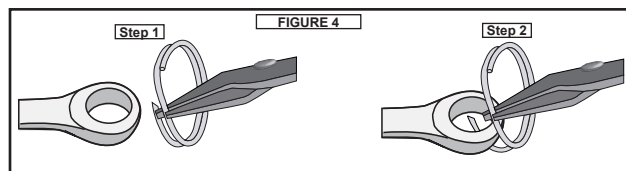
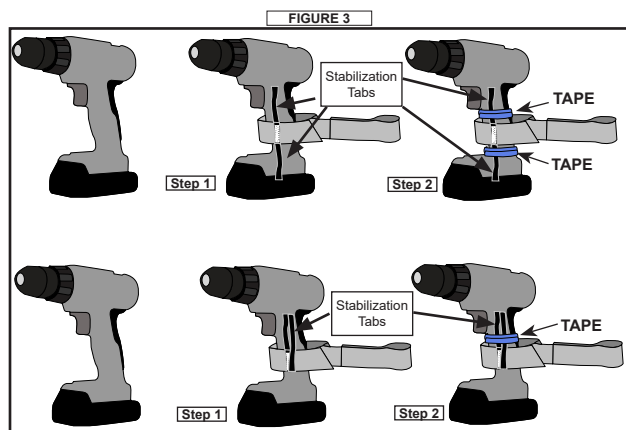
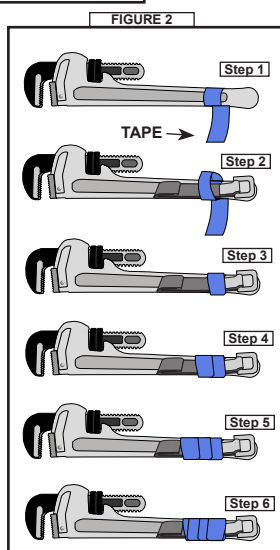
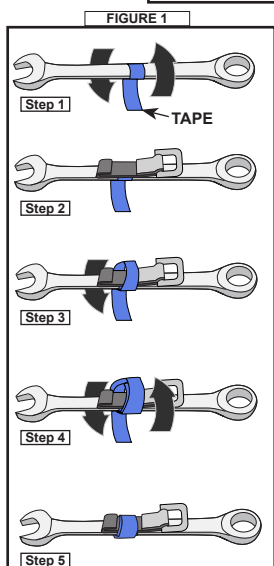

SW431 and SW432 elasticated lanyards are offered in 35 lbs capacity 50" to 62" length
SW433 and SW434 elasticated lanyards are offered in 80 lbs capacity 66.5" to 80.5" length

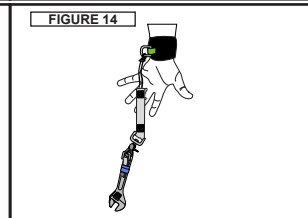
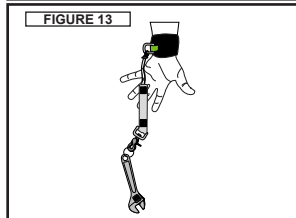
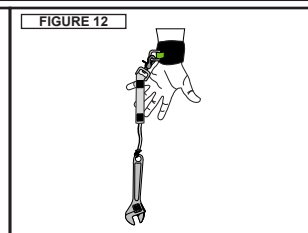
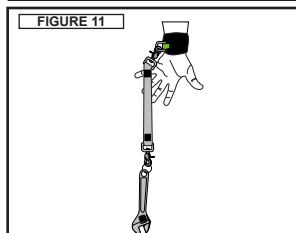
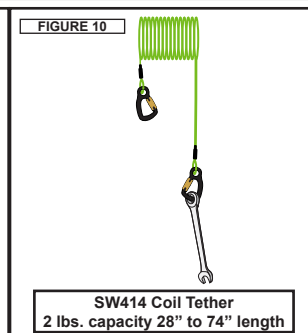
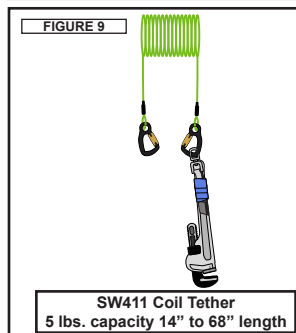
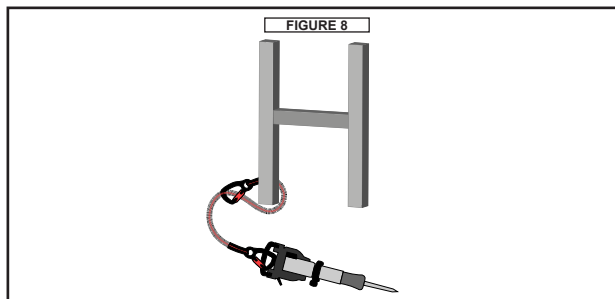

MAINTENANCE & STORAGE

ToolCuff Tool Lanyards can be cleaned with water and mild soap and hung to air dry. Do not use chemical cleaners, harsh detergents, or solvents. Do not dry ToolCuff products with heat.

Hardware can be wiped off with a clean, dry cloth.

ToolCuff Tool Lanyards should be stored in a cool, dry, and clean environment. Do not store in direct sunlight or where chemical vapors could come in contact with the harness.

WARRANTY

SAFEWAZE™ warrants its products are free from defects in materials and construction under normal use and service. Liability is not accepted for abuse, modification, improper use, destructive activity and contaminated exposure.

INSPECTION

- ToolCuff Tool Lanyards shall be inspected prior to each use by the user and at least annually by a Competent Person. Annual inspections shall be documented. Severity of conditions during use may necessitate increased frequency of documented inspections.
- Lanyards that fail inspection MUST be removed from service and destroyed immediately.
- All components of the Lanyards shall be inspected. Hardware inspection will include all Connectors, D-rings, and Web.
- Connectors, and D-rings should have smooth surfaces with no indication of corrosion or damage that could negatively impact lanyard webbing.

Lanyard Webbing, Connectors, D-rings and other components must be inspected for:

- | | |
|----------------------------|---|
| 1. Excessive Wear | 8. Mold or Mildew |
| 2. Cuts | 9. Broken Stitches |
| 3. Abrasions | 10. Alterations and Additions |
| 4. Undue Stretching | 11. Rust, Oxidation, or Corrosion |
| 5. Chemical Exposure | 12. Legibility of Labeling |
| 6. Burns or Excessive Heat | 13. Deformation |
| 7. Welding Spatter | 14. Discoloration or Abraded Appearance |

IF ANY OF THESE CONDITIONS EXIST
LANYARD MUST BE REMOVED FROM SERVICE

INSPECTION LOG

| Date | Inspection Items Noted | Corrective Action | Initials |
|------|------------------------|-------------------|----------|
| | | | |
| | | | |
| | | | |
| | | | |



SAFEWAZE™
322 Industrial Court
Concord, NC 28025

PHONE: 704-262-7893
FAX: 704-262-9051
EMAIL: info@safewaze.com
Web: safewaze.com